

# nayo S

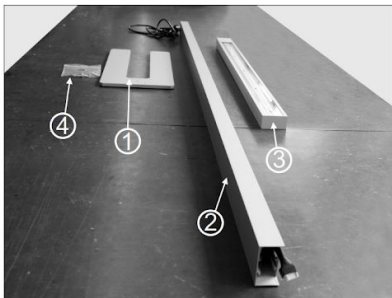

Productcode 220174

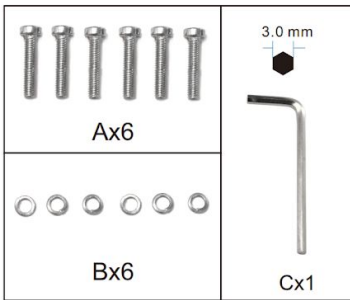
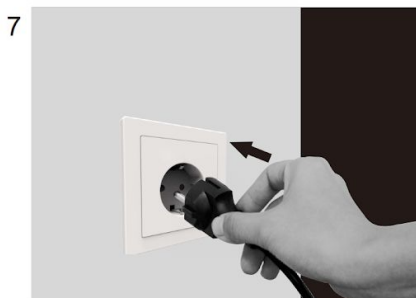
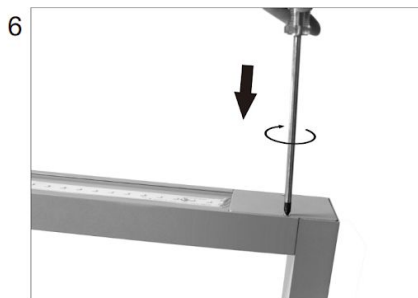
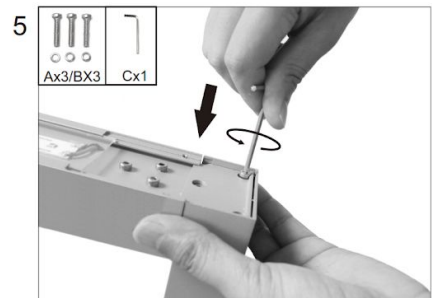
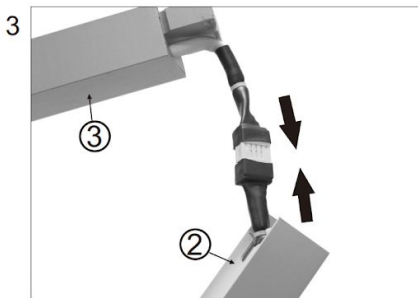
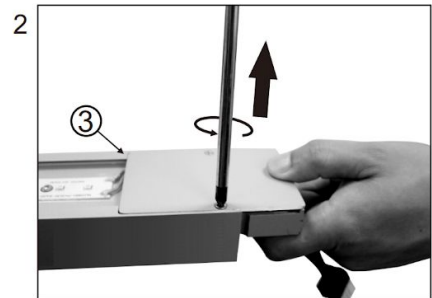
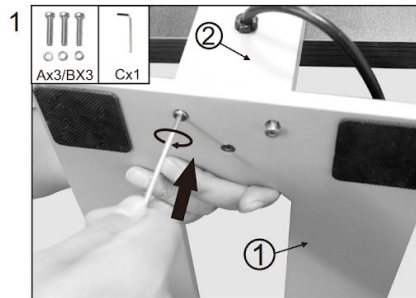

Product list: ① base plate ② pole  
③ lamp body ④ accessories bag

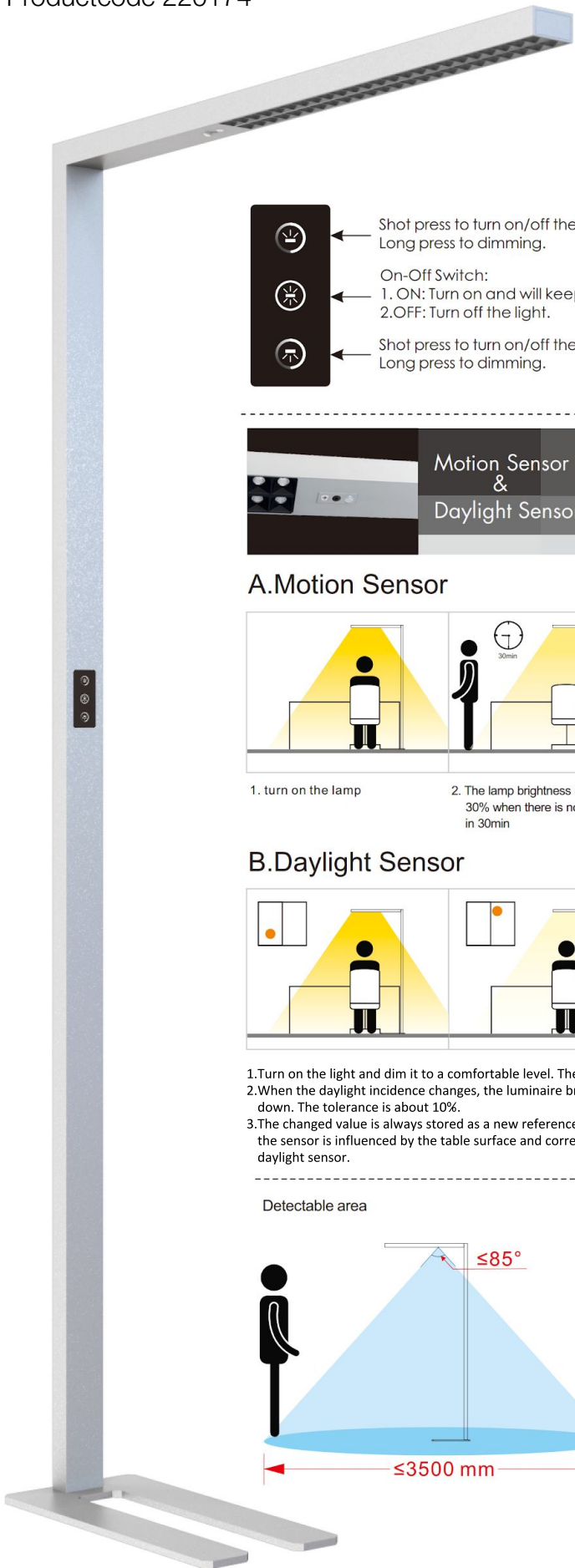



-  ← Shot press to turn on/off the indirect light.  
Long press to dimming.
-  ← On-Off Switch:  
1. ON: Turn on and will keep light same as previous status automatically.  
2.OFF: Turn off the light.
-  ← Shot press to turn on/off the direct light.  
Long press to dimming.

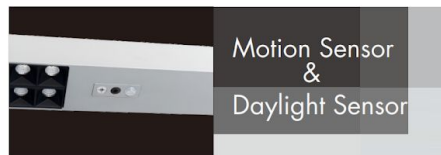

## A.Motion Sensor

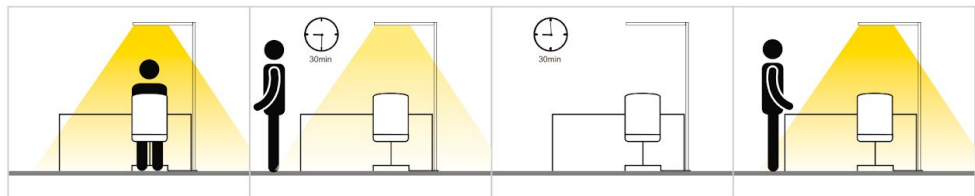

1. turn on the lamp
2. The lamp brightness reduce to 30% when there is no presence in 30min
3. After another 30min, the lamp switches off automatically when still no presence detected
- 4.The lamp will switches on automatically at once when there is presence detected.

## B.Daylight Sensor

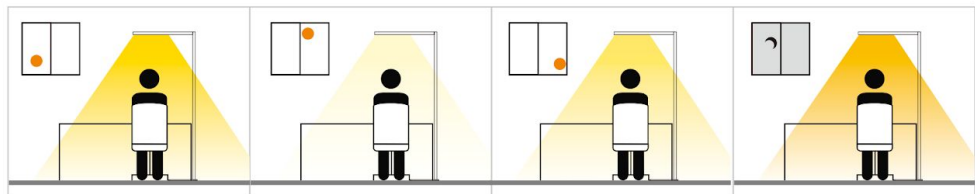

- 1.Turn on the light and dim it to a comfortable level. The daylight sensor stores this value and uses it as a reference for light control.
- 2.When the daylight incidence changes, the luminaire brightness automatically adjusts to the new lighting conditions and dims up or down. The tolerance is about 10%.
- 3.The changed value is always stored as a new reference when manual dimming is carried out again. Attention: The measured value of the sensor is influenced by the table surface and corresponding objects. The measurement is made at an angle of 20° below the daylight sensor.

Detectable area

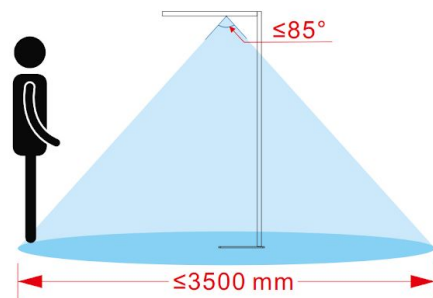

Here to tell you how to play **Motion Sensor & Daylight Sensor**



Dip switches	information	Motion sensor	Daylight sensor
0	↔	OFF	OFF
1	→	ON	OFF
2	→	ON	ON
3	↔	OFF	ON

Adjust the dip switch to the module by screwdriver.