

asali

Montageanleitung Lichtbandeinsatz

Mounting instructions for continuous row insert

Instructions de montage luminaire pour chemin lumineux

Istruzioni di montaggio Apparecchio per fila continua

neva lux

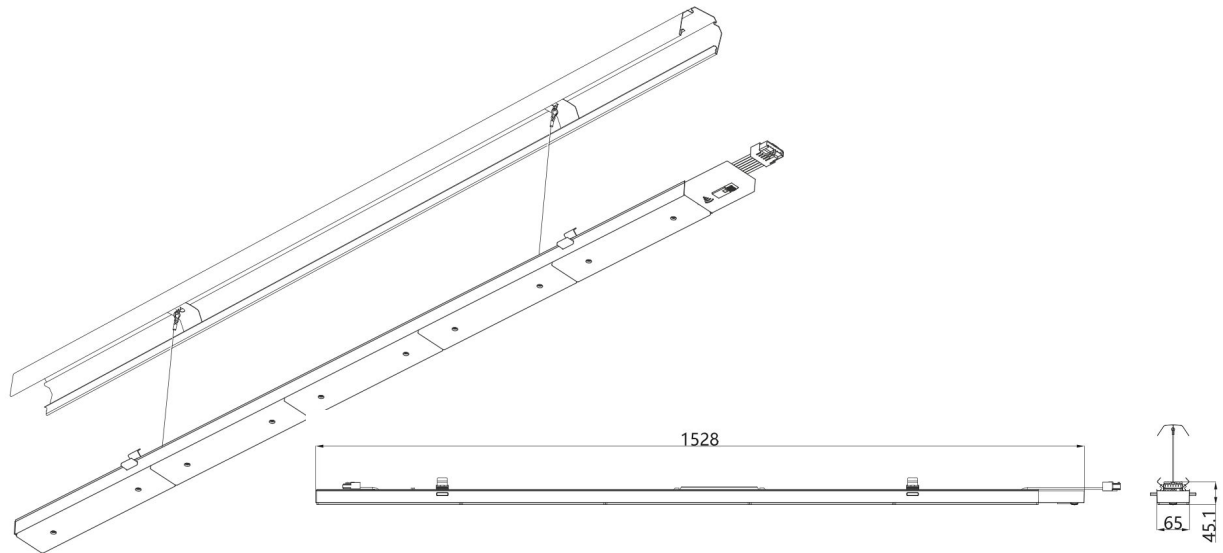

1

Alte Durchgangsverdrahtung und Konnektoren entfernen
Remove old through-wiring and connectors
Retirer l'ancien câblage traversant et les connecteurs
Rimuovere il vecchio cablaggio passante e i connettori

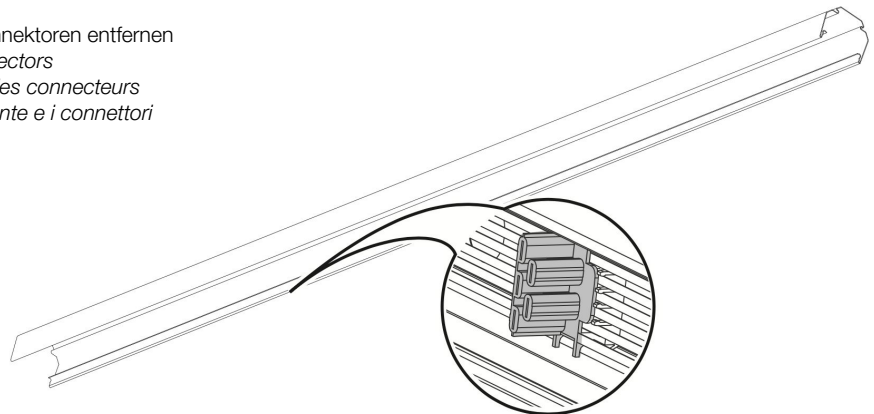

2

Fallsicherungen einrasten
Snap in fall protection
Cliquer la protection contre les chutes
Inserire la protezione anticaduta

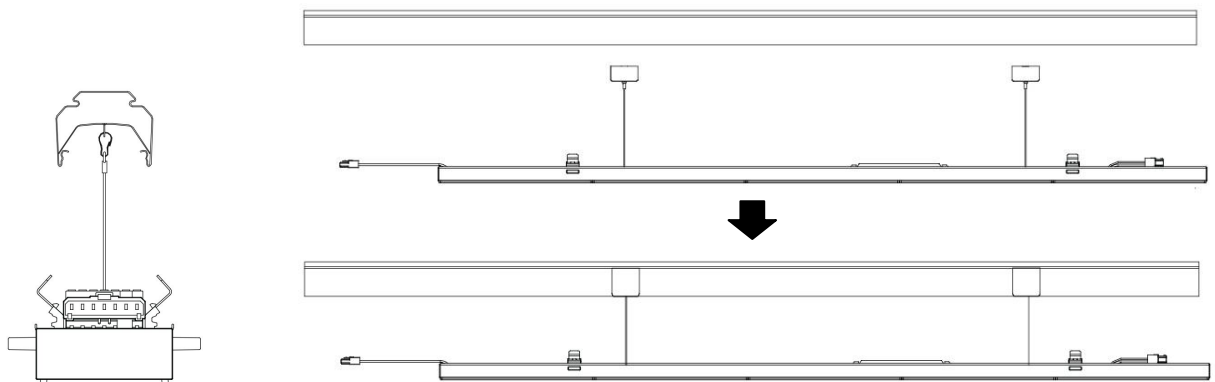

asali

Montageanleitung Lichtbandeinsatz

Mounting instructions for continuous row insert

Instructions de montage luminaire pour chemin lumineux

Istruzioni di montaggio Apparecchio per fila continua

neva lux

3

Anschluss mit Hilfe von WAGO Steckern

Connection using WAGO connectors

Raccordement à l'aide de connecteurs WAGO

Collegamento tramite connettori WAGO

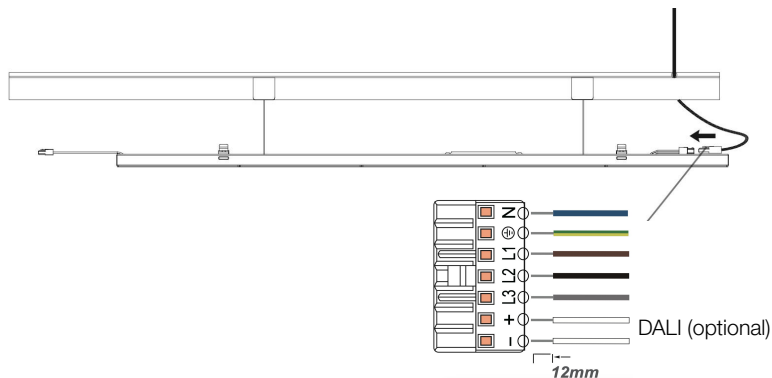

4

Montage des ersten Modules

Mounting the first module

Montage du premier module

Montaggio del primo modulo

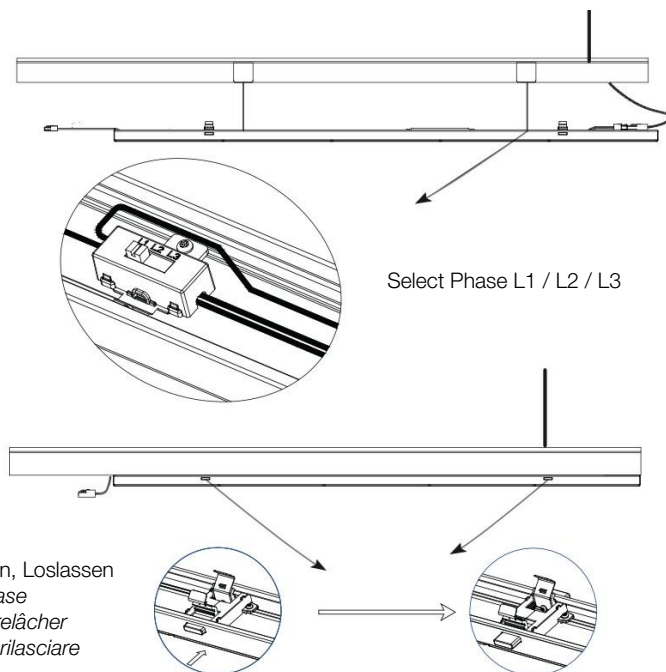

5a

Montage weiterer Module

Mounting further modules

Montage d'autres modules

Montaggio di altri moduli

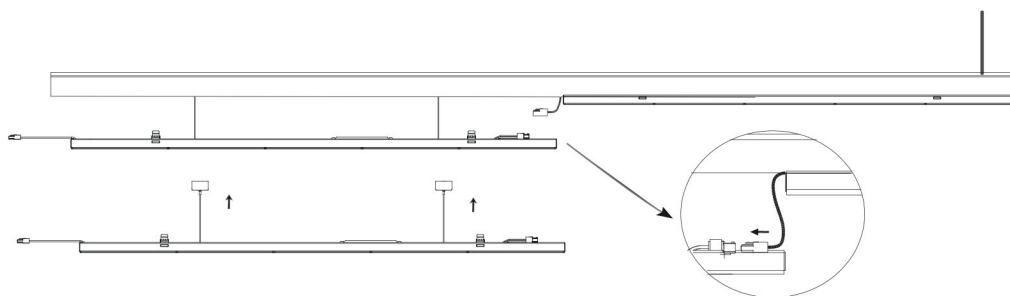

5b

Montage Blindabdeckung

Mounting blind cover

Montage du cache

Montaggio copertura cieca

